

Patient: _____

Date: _____

Leuprolide Acetate/Lupron

Lupron is an analog of gonadotropin releasing hormone (GnRH), which has a suppressive action on the pituitary gland.

Lupron prevents premature ovulation, as well as improves the recruitment of multiple follicles. Side effects of this medication include, but are not limited to, hot flashes, headaches, breast tenderness and redness, bruising, or tenderness at the injection site.



Please discuss any experienced side effects with your physician or nurse.

Instructions for Using Leuprolide Acetate/Lupron

Start Lupron 20 units/.2 cc subcutaneously on _____.

On _____ you will decrease your Lupron to 10 units/.1 cc a day.

Please administer the Lupron once a day at the same dose and at the same time each day until instructed by our office to do otherwise. Starting another period during the Lupron phase is normal and can be expected. Lupron does not need to be refrigerated, but do not store in an area above 77 F.

Preparing the Medication

Draw the medication into the syringe using the following method:

- Carefully flip the lid of the vial off if using the multi-dose vial for the first time, or wipe the top of the vial with an alcohol swab.
- Use a new sterile syringe/needle and carefully twist the needle cover off the syringe.
- Draw air into the syringe by pulling back the plunger until the top of the black stopper has reached 20units/.2cc (or the amount you have been instructed to give).
- Insert the needle straight down into the vial through the rubber stopper and push the plunger all the way in until the black stopper has returned to the top of the syringe.
- Turn the vial upside down without removing the needle, making sure the needle tip remains in the liquid, and pull the plunger back to withdraw the desired amount.
Withdraw the needle from the vial.
- Tap the syringe with the needle pointed up to get rid of any air bubbles.
- Gently push the plunger in to prime the needle, so no air remains in the syringe.



You are now ready to administer the injection.

Injecting the Medication

For subcutaneous injections:

Your nurse will help you choose an appropriate injection site (abdomen, thigh, or upper arm). Be sure to rotate sites with each injection.

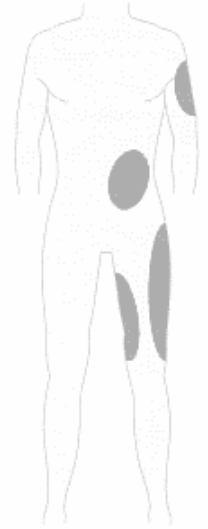

1. Swab the desired area with an alcohol swab and allow to air dry.
2. Pinch the desired skin with one hand and insert the syringe at a 90 degree angle with the other hand using a quick and smooth motion.
3. Gently pull back the plunger on the syringe to check for blood. If no blood appears, inject the entire solution by gently pushing the plunger all the way in until all the medication is injected. If blood appears in the syringe, withdraw the needle and prepare a new needle and injection site and repeat the process.
4. Once the medication has been injected successfully, release the skin, pull the needle out and discard the syringe and needle in your red Biohazard container. If bleeding is noted at the site of injection, apply gentle pressure, or ice to help relieve any swelling, or pain.

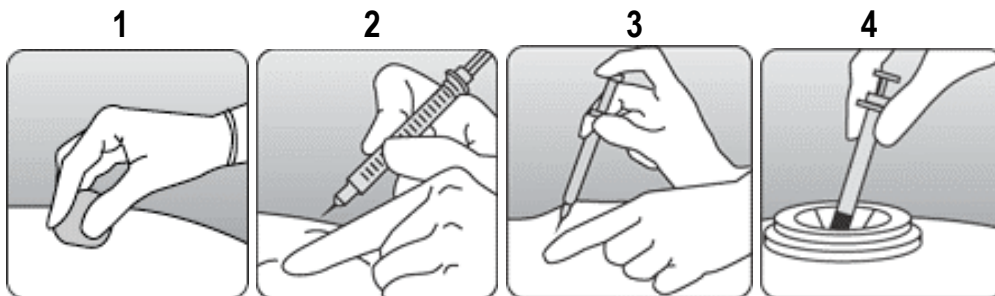

If you have questions regarding the use, or procedure methods for this medication, please contact our office prior to administering your injection. (213) 975-9990.